

### TECHNICAL SPECIFICATION

MODEL	OPENINGS	VOLUME (Ltrs.)	DIMENSIONS (mm)											BASE	WEIGHT OF VESSEL WITH BASE (Kg)
			D1	D	H±10	H1	H2	L	F	WA	WLA	WB	WLB		
30X65	4" TOP	631.8	768	752	1710	1680	1080	159	150	9	4	9	3	Standard	47.6
30X72	4" TOP	711.3	768	752	1890	1860	1270	159	150	9	4	9	3	Standard	51.6

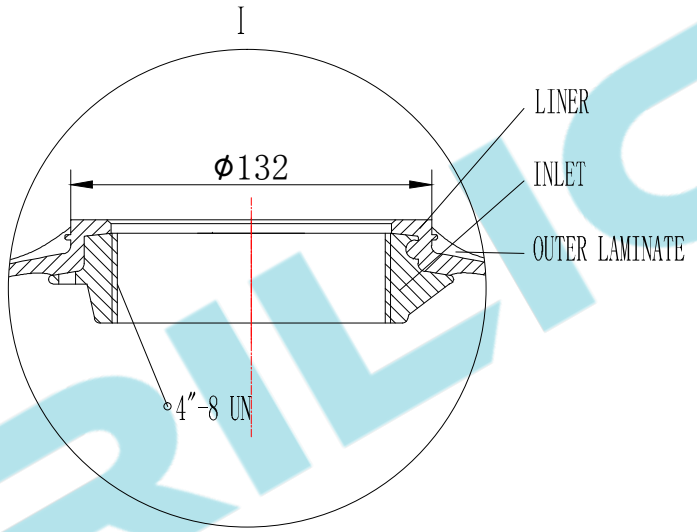

4"-8UN Internal Thread	
PITCH DIA	3.918-3.930"
MINOR DIA	3.865-3.875"
MAJOR DIA	4.000-4.010"

NOTES:	
1. TANK MUST MEET ALL APPLICABLE SPECIFICATIONS OF NSF/ANSI 044 STANDARD, LATEST REVISION.	
2. OPERATING SPECIFICATIONS:	
A. MAXIMUM WORKING PRESSURE:	10.5BAR(150PSI)
B. TEMPERATURE RANGE:	1-50°C (34-122°F)
C. MAXIMUM VACUUM:	17kPa (5" Hg)

	NAME	DATE	VERSION NO.	CHANGING DESCRIPTION	CHANGING DATE
DESIGN					
INSPECTION			INDUSTRIAL VESSEL		
			MODEL: 30" (4" TOP)	DRAWING NO.	NY-WI-DR-TE-PR-SA-VE0030400
APPROVAL			MATERIAL FRP UNIT mm	VERSION NO. 1.1	TOTAL PAGE 1 OF 1 DO NOT MEASURE THE DIMENSIONS.